

Backing Rings FRP

by SMC Hot Pressing

Resin Polyester / Black colour



ROTEC
Composite Group

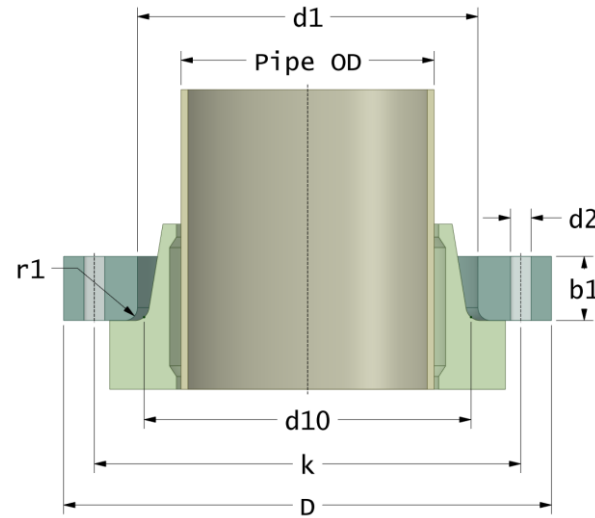

with drillings according to

EN1092 PN 10

suitable for PE & PP stub flange

January 2025

Page 1/2

DN	Pmax	Pipe OD	D	d1	d10	r1	k	Holes	d2	b1	Article Number	
(mm)	(bar)	(mm)	(mm)	(mm)	(mm)	(mm)	(mm)	(no.)	(mm)	(mm)	(code)	
15	16	20	98	28	27	3	65	4	14	15	BRPPE-15-28-16/16	
20	16	25	116	34	33	3	75	4	14	15	BRPPE-20-34-16/16	
25	16	32	116	42	40	3	85	4	14	15	BRPPE-25-42-16/16	
32	16	40	140	51	50	3	100	4	18	16	BRPPE-32-51-16/16	
40	16	50	154	62	61	3	110	4	18	18	BRPPE-40-62-16/16	
50	16	63	164	78	77	4	125	4	18	18	BRPPE-50-78-16/16	
65	16	75	184	92	89	4	145	4	18	20	BRPPE-65-92-16/16	
80	10	90	200	108	107	4	160	8	18	23	BRPPE-80-108-10/16	
100	6	110	228	128	125	5	180	8	18	20	BRPPE-100-128-06/16	
100	10	110	228	128	125	5	180	8	18	25	BRPPE-100-128-10/16	
100	6	125	228	134	133	5	180	8	18	20	BRPPE-100-134-06/16	
100	10	125	228	134	133	5	180	8	18	25	BRPPE-100-134-10/16	
125	6	140	254	158	155	5	210	8	18	22	BRPPE-125-158-06/16	
125	10	140	254	158	155	5	210	8	18	28	BRPPE-125-158-10/16	
150	6	160	284	178	175	5	240	8	22	25	BRPPE-150-178-06/16	
150	10	160	284	178	175	5	240	8	22	32	BRPPE-150-178-10/16	
150	6	180	284	185	182	5	240	8	22	25	BRPPE-150-185-06/16	
150	10	180	284	185	182	5	240	8	22	32	BRPPE-150-185-10/16	

Backing Rings FRP

by SMC Hot Pressing

Resin Polyester / Black colour

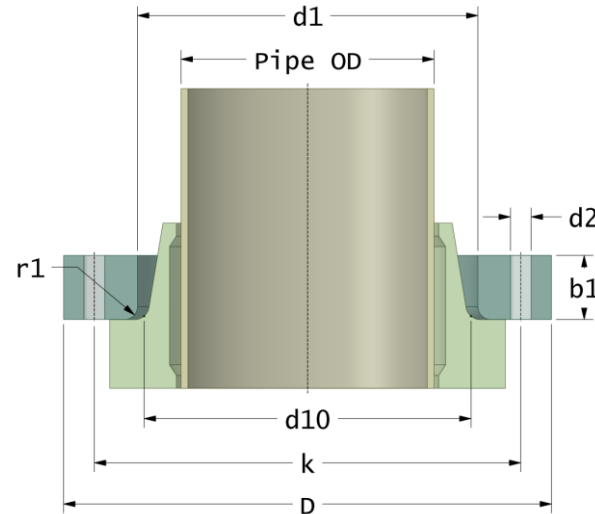

with drillings according to **EN1092 PN 10**
suitable for **PE & PP stub flange**

January 2025

Page 2/2

DN (mm)	Pmax (bar)	Pipe OD (mm)	D (mm)	d1 (mm)	d10 (mm)	r1 (mm)	k (mm)	Holes (no.)	d2 (mm)	b1 (mm)	Article Number (code)
200	6	200	342	235	232	6	295	8	22	30	BRPPE-200-235-06/10
200	10	200	342	235	232	6	295	8	22	38	BRPPE-200-235-10/10
200	6	225	342	238	237	6	295	8	22	30	BRPPE-200-238-06/10
200	10	225	342	238	237	6	295	8	22	38	BRPPE-200-238-10/10
250	6	250	405	288	285	6	350	12	22	32	BRPPE-250-288-06/10
250	10	250	405	288	285	6	350	12	22	42	BRPPE-250-288-10/10
250	6	280	405	294	293	6	350	12	22	32	BRPPE-250-294-06/10
250	10	280	405	294	293	6	350	12	22	42	BRPPE-250-294-10/10
300	6	315	458	338	335	6	400	12	22	38	BRPPE-300-338-06/10
300	10	315	458	338	335	6	400	12	22	48	BRPPE-300-338-10/10

Larger diameters (up to DN 3600) or higher pressure ratings; see BR type (by RTM)

