

Backing Rings FRP

by SMC Hot Pressing

Resin Vinylester / off-white colour

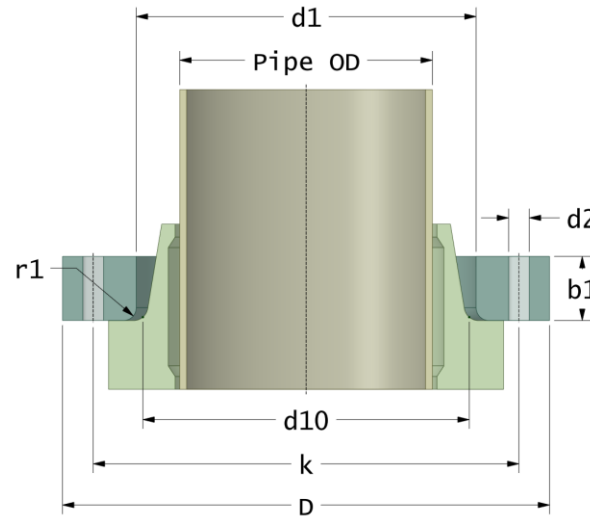

ROTEC
Composite Group

with drillings according to

EN1092 PN10

suitable for **GRP stub flange**

January 2025

Page 1/2

| DN | Pmax | D | d1 | d10 | r1 | k | Holes | d2 | b1 | Article Number | |
|------|-------|------|------|------|------|------|-------|------|------|-------------------|--|
| (mm) | (bar) | (mm) | (mm) | (mm) | (mm) | (mm) | (no.) | (mm) | (mm) | (code) | |
| 15 | 16 | 98 | 34 | 33 | 3 | 65 | 4 | 14 | 15 | BRP-15-34-16/16 | |
| 25 | 16 | 116 | 51 | 50 | 3 | 85 | 4 | 14 | 15 | BRP-25-51-16/16 | |
| 32 | 16 | 140 | 59 | 58 | 3 | 100 | 4 | 18 | 16 | BRP-32-59-16/16 | |
| 40 | 16 | 154 | 69 | 68 | 3 | 110 | 4 | 18 | 18 | BRP-40-69-16/16 | |
| 50 | 16 | 164 | 83 | 82 | 4 | 125 | 4 | 18 | 18 | BRP-50-83-16/16 | |
| 65 | 16 | 184 | 96 | 95 | 4 | 145 | 4 | 18 | 20 | BRP-65-96-16/16 | |
| 80 | 10 | 200 | 112 | 111 | 4 | 160 | 8 | 18 | 23 | BRP-80-112-10/16 | |
| 100 | 6 | 228 | 134 | 133 | 5 | 180 | 8 | 18 | 20 | BRP-100-134-06/16 | |
| 100 | 10 | 228 | 134 | 133 | 5 | 180 | 8 | 18 | 25 | BRP-100-134-10/16 | |
| 125 | 6 | 254 | 161 | 160 | 5 | 210 | 8 | 18 | 22 | BRP-125-161-06/16 | |
| 125 | 10 | 254 | 161 | 160 | 5 | 210 | 8 | 18 | 28 | BRP-125-161-10/16 | |
| 150 | 6 | 284 | 189 | 188 | 5 | 240 | 8 | 22 | 25 | BRP-150-189-06/16 | |
| 150 | 10 | 284 | 189 | 188 | 5 | 240 | 8 | 22 | 34 | BRP-150-189-10/16 | |
| 200 | 6 | 342 | 238 | 237 | 6 | 295 | 8 | 22 | 32 | BRP-200-238-06/10 | |
| 200 | 10 | 342 | 238 | 237 | 6 | 295 | 8 | 22 | 38 | BRP-200-238-10/10 | |
| 200 | 12 | 342 | 238 | 237 | 6 | 295 | 8 | 22 | 42 | BRP-200-238-12/10 | |
| 250 | 6 | 405 | 294 | 293 | 6 | 350 | 12 | 22 | 34 | BRP-250-294-06/10 | |
| 250 | 10 | 405 | 294 | 293 | 6 | 350 | 12 | 22 | 42 | BRP-250-294-10/10 | |
| 250 | 12 | 405 | 294 | 293 | 6 | 350 | 12 | 22 | 52 | BRP-250-294-12/10 | |

Backing Rings FRP

by SMC Hot Pressing

Resin Vinylester / off-white colour

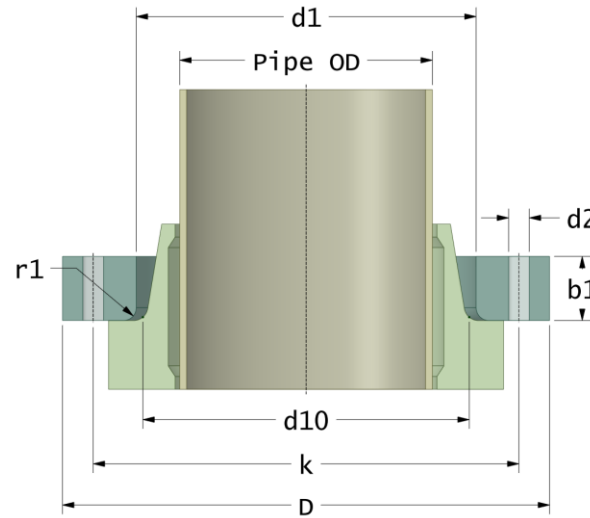

with drillings according to

EN1092 PN10

suitable for **GRP stub flange**

January 2025

Page 2/2

| DN | Pmax | D | d1 | d10 | r1 | k | Holes | d2 | b1 | Article Number | |
|------|-------|------|------|------|------|------|-------|------|------|-------------------|--|
| (mm) | (bar) | (mm) | (mm) | (mm) | (mm) | (mm) | (no.) | (mm) | (mm) | (code) | |
| 300 | 6 | 458 | 344 | 343 | 6 | 400 | 12 | 22 | 38 | BRP-300-344-06/10 | |
| 300 | 10 | 458 | 344 | 343 | 6 | 400 | 12 | 22 | 48 | BRP-300-344-10/10 | |
| 300 | 12 | 458 | 344 | 343 | 6 | 400 | 12 | 22 | 60 | BRP-300-344-12/10 | |

Larger diameters (up to DN 3600) or higher pressure ratings; see BR type (by RTM)