

# Backing Rings FRP

by SMC Hot Pressing

Resin Polyester / Gray colour



**ROTEC**  
Composite Group

with drillings according to

**ANSI B16.5 Class 150**

suitable for **PVC stub flange**

January 2025

Page 1/2

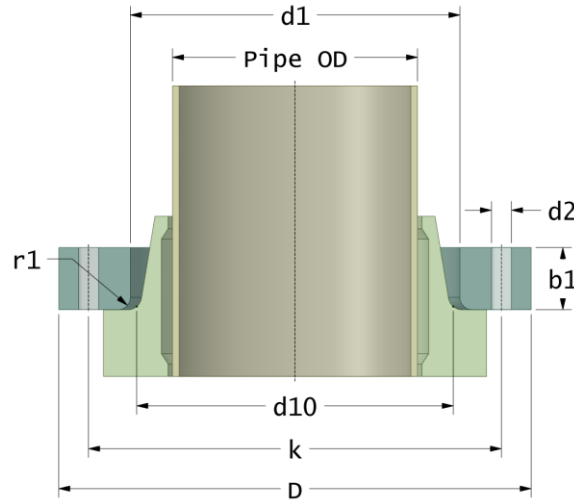

DN	Pmax	Pipe OD	D	d1	d10	r1	k	Holes	d2	b1	Article Number	
(mm)	(bar)	(mm)	(mm)	(mm)	(mm)	(mm)	(mm)	(no.)	(mm)	(mm)	(code)	
15	16	20	98	28	27	3	60	4	16	15	BRPVC-15-28-16/150	
20	16	25	98	34	33	3	70	4	16	15	BRPVC-20-34-16/150	
25	16	32	116	42	41	3	79	4	16	15	BRPVC-25-42-16/150	
32	16	40	116	51	50	3	89	4	16	16	BRPVC-32-51-16/150	
40	16	50	140	62	61	3	98	4	16	18	BRPVC-40-62-16/150	
50	16	63	154	78	76	3	121	4	19	18	BRPVC-50-78-16/150	
65	10	75	184	92	90	3	140	4	19	18	BRPVC-65-92-10/150	
65	16	75	184	92	90	3	140	4	19	22	BRPVC-65-92-16/150	
80	6	90	200	110	108	3	152	4	19	18	BRPVC-80-110-06/150	
80	10	90	200	110	108	3	152	4	19	23	BRPVC-80-110-10/150	
80	16	90	200	110	108	3	152	4	19	28	BRPVC-80-110-16/150	
100	6	125	228	134	132	3	190	8	19	20	BRPVC-100-134-06/150	
100	10	125	228	134	132	3	190	8	19	25	BRPVC-100-134-10/150	
100	16	125	228	134	132	3	190	8	19	30	BRPVC-100-134-16/150	
125	6	140	254	167	165	3	216	8	22	22	BRPVC-125-167-06/150	
125	10	140	254	167	165	3	216	8	22	28	BRPVC-125-167-10/150	
125	16	140	254	167	165	3	216	8	22	34	BRPVC-125-167-16/150	
150	6	180	284	190	188	3	241	8	22	25	BRPVC-150-190-06/150	
150	10	180	284	190	188	3	241	8	22	34	BRPVC-150-190-10/150	
150	16	180	284	190	188	3	241	8	22	40	BRPVC-150-190-16/150	

# Backing Rings FRP

by SMC Hot Pressing

Resin Polyester / Gray colour



**ROTEC**  
Composite Group

with drillings according to

**ANSI B16.5 Class 150**

suitable for **PVC stub flange**

January 2025

Page 2/2

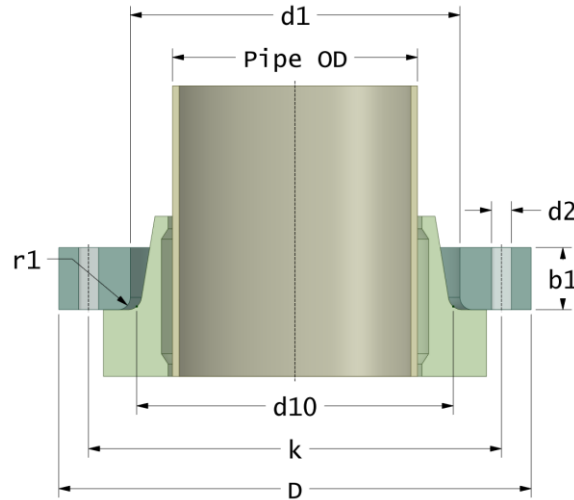

DN	Pmax	Pipe OD	D	d1	d10	r1	k	Holes	d2	b1	Article Number	
(mm)	(bar)	(mm)	(mm)	(mm)	(mm)	(mm)	(mm)	(no.)	(mm)	(mm)	(code)	
200	4	200	342	226	224	3	298	8	22	25	BRPVC-200-226-04/150	
200	10	200	342	226	224	3	298	8	22	38	BRPVC-200-226-10/150	
200	16	200	342	226	232	3	298	8	22	48	BRPVC-200-226-16/150	
200	4	200	342	235	232	3	298	8	22	25	BRPVC-200-235-04/150	
200	10	200	342	235	248	3	298	8	22	38	BRPVC-200-235-10/150	
200	16	200	342	235	248	3	298	8	22	48	BRPVC-200-235-16/150	
200	4	225	342	252	247	3	298	8	22	25	BRPVC-200-252-04/150	
200	10	225	342	252	247	3	298	8	22	38	BRPVC-200-252-10/150	
200	16	225	342	252	247	3	298	8	22	48	BRPVC-200-252-16/150	
250	4	250	405	277	273	3	362	12	26	28	BRPVC-250-277-04/150	
250	10	250	405	277	273	3	362	12	26	42	BRPVC-250-277-10/150	
250	16	250	405	277	273	3	362	12	26	54	BRPVC-250-277-16/150	
250	4	280	405	310	306	3	362	12	26	28	BRPVC-250-310-04/150	
250	10	280	405	310	306	3	362	12	26	42	BRPVC-250-310-10/150	
250	16	280	405	310	306	3	362	12	26	54	BRPVC-250-310-16/150	
300	4	315	485	350	347	3	432	12	26	35	BRPVC-300-350-04/150	
300	10	315	485	350	347	3	432	12	26	52	BRPVC-300-350-10/150	