

# Backing Rings FRP

by SMC Hot Pressing

Resin Polyester / Black colour



**ROTEC**  
Composite Group

with drillings according to

**ANSI B16.5 Class 150**

suitable for **PE & PP stub flange**

January 2025

Page 1/2

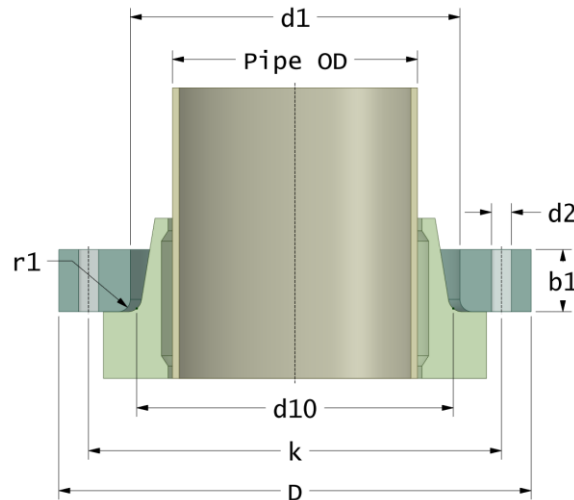

DN	Pmax	Pipe OD	D	d1	d10	r1	k	Holes	d2	b1	Article Number	
(mm)	(bar)	(mm)	(mm)	(mm)	(mm)	(mm)	(mm)	(no.)	(mm)	(mm)	(code)	
15	16	20	98	28	27	3	60	4	16	15	BRPPE-15-28-16/150	
20	16	25	98	34	33	3	70	4	16	15	BRPPE-20-34-16/150	
25	16	32	116	42	40	3	79	4	16	15	BRPPE-25-42-16/150	
32	16	40	116	51	50	3	89	4	16	16	BRPPE-32-51-16/150	
40	16	50	140	62	61	3	98	4	16	18	BRPPE-40-62-16/150	
50	16	63	154	78	75	4	121	4	19	18	BRPPE-50-78-16/150	
65	10	75	184	92	89	4	140	4	19	16	BRPPE-65-92-10/150	
65	16	75	184	92	89	4	140	4	19	20	BRPPE-65-92-16/150	
80	6	90	200	108	107	4	152	4	19	18	BRPPE-80-108-06/150	
80	10	90	200	108	107	4	152	4	19	23	BRPPE-80-108-10/150	
80	16	90	200	108	107	4	152	4	19	28	BRPPE-80-108-16/150	
100	6	110	228	128	125	5	190	8	19	20	BRPPE-100-128-06/150	
100	10	110	228	128	125	5	190	8	19	25	BRPPE-100-128-10/150	
100	16	110	228	128	125	5	190	8	19	30	BRPPE-100-128-16/150	
100	6	125	228	134	133	5	190	8	19	20	BRPPE-100-134-06/150	
100	10	125	228	134	133	5	190	8	19	25	BRPPE-100-134-10/150	
100	16	125	228	134	133	5	190	8	19	30	BRPPE-100-134-16/150	
125	6	140	254	158	155	5	216	8	22	22	BRPPE-125-158-06/150	
125	10	140	254	158	155	5	216	8	22	28	BRPPE-125-158-10/150	
125	16	140	254	158	155	5	216	8	22	34	BRPPE-125-158-16/150	

# Backing Rings FRP

by SMC Hot Pressing

Resin Polyester / Black colour



**ROTEC**  
Composite Group

with drillings according to

**ANSI B16.5 Class 150**

suitable for **PE & PP stub flange**

January 2025

Page 2/2

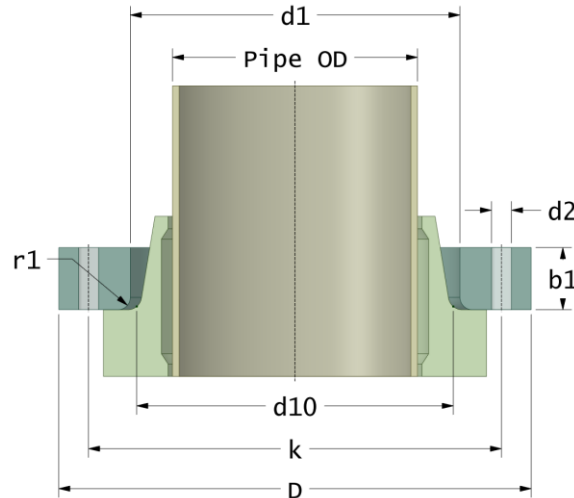

DN	Pmax	Pipe OD	D	d1	d10	r1	k	Holes	d2	b1	Article Number	
(mm)	(bar)	(mm)	(mm)	(mm)	(mm)	(mm)	(mm)	(no.)	(mm)	(mm)	(code)	
150	6	160	284	178	175	5	241	8	22	25	BRPPE-150-178-06/150	
150	10	160	284	178	175	5	241	8	22	32	BRPPE-150-178-10/150	
150	16	160	284	178	175	5	241	8	22	40	BRPPE-150-178-16/150	
150	6	180	284	185	182	5	241	8	22	25	BRPPE-150-185-06/150	
150	10	180	284	185	182	5	241	8	22	32	BRPPE-150-185-10/150	
150	16	180	284	185	182	5	241	8	22	40	BRPPE-150-185-16/150	
200	6	200	342	235	232	6	298	8	22	30	BRPPE-200-235-06/150	
200	10	200	342	235	232	6	298	8	22	38	BRPPE-200-235-10/150	
200	16	200	342	235	232	6	298	8	22	48	BRPPE-200-235-16/150	
200	6	225	342	238	237	6	298	8	22	30	BRPPE-200-238-06/150	
200	10	225	342	238	237	6	298	8	22	38	BRPPE-200-238-10/150	
200	16	225	342	238	237	6	298	8	22	48	BRPPE-200-238-16/150	
250	6	250	405	288	285	6	362	12	26	32	BRPPE-250-288-06/150	
250	10	250	405	288	285	6	362	12	26	42	BRPPE-250-288-10/150	
250	16	250	405	288	285	6	362	12	26	54	BRPPE-250-288-16/150	
250	6	280	405	294	293	6	362	12	26	32	BRPPE-250-294-06/150	
250	10	280	405	294	293	6	362	12	26	42	BRPPE-250-294-10/150	
250	16	280	405	294	293	6	362	12	26	54	BRPPE-250-294-16/150	
300	6	315	485	338	335	6	432	12	26	38	BRPPE-300-338-06/150	
300	10	315	485	338	335	6	432	12	26	52	BRPPE-300-338-10/150	